

TRACKED AERIAL PLATFORMS

CHERRY PICKER·IE



Sales & Service



Bespoke Design



MEWP Training



Handling Solutions

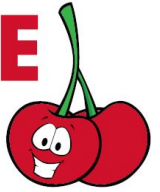

GOLDLIFT 17.80XL MS

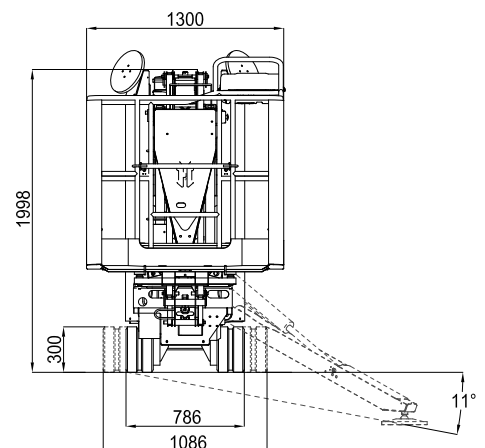
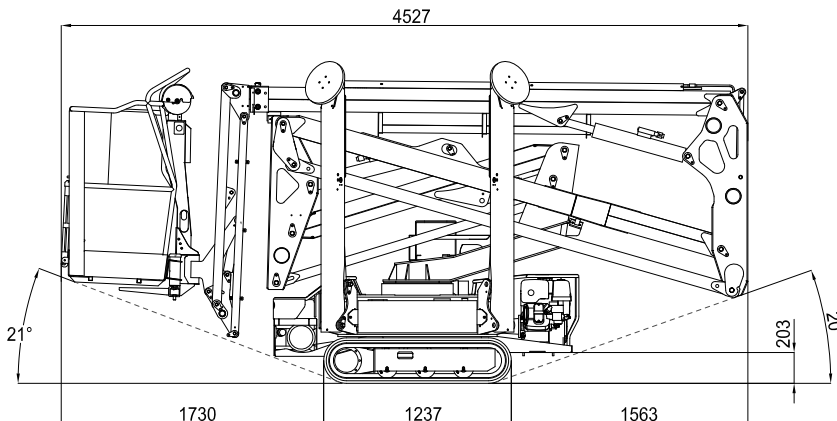
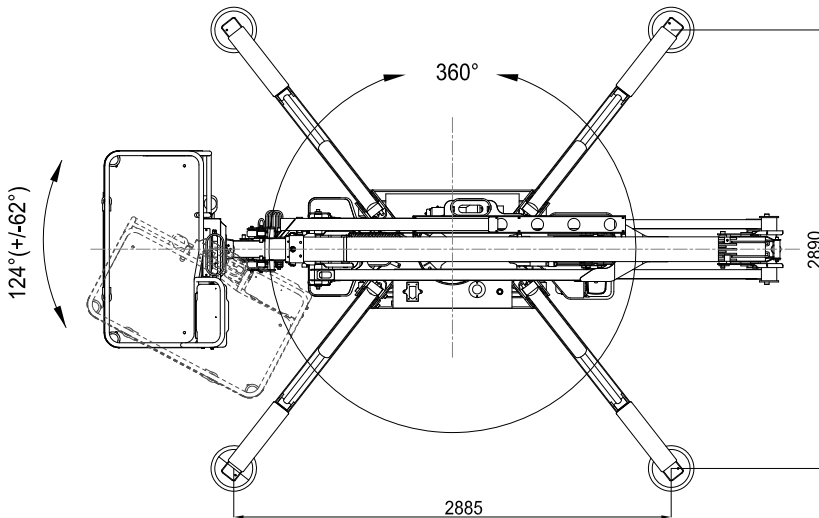

GOLDLIFT 17.80XL III

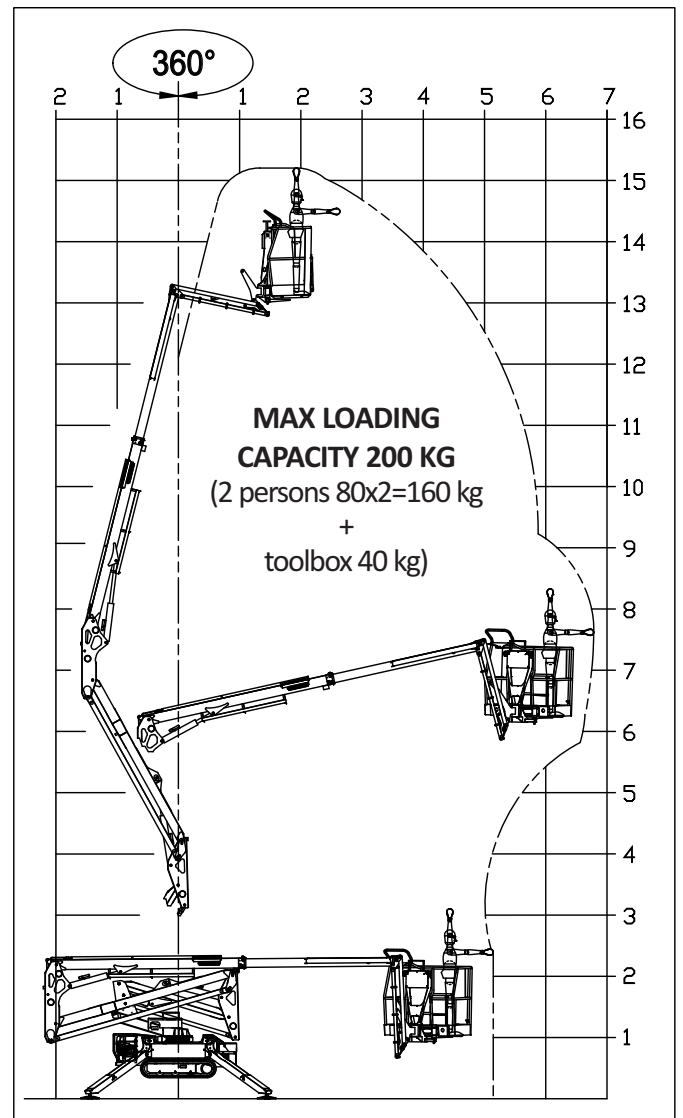
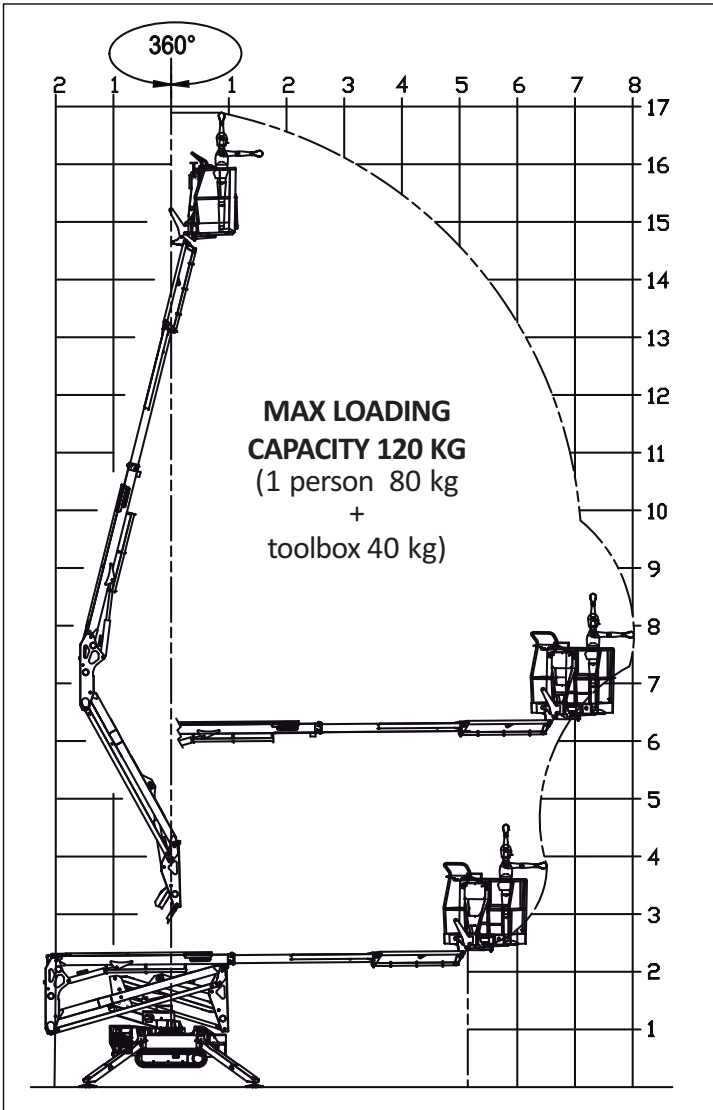

TRACKED AERIAL PLATFORMS



GOLDLIFT 17.80XL III S

PETROL ENGINE

Brand.....HONDA
Type.....iGX440 cc
Pistons no. and displacement single-cylinder 440 cc
Max. gross power..... 12,7 HP - 9,5Kw @ 3600 rpm
Electrical start 12 volt

DIESEL ENGINE

BrandHATZ
Type..... 1B40 - HD Autorev
Pistons no. and displacement single-cylinder 462 cc
Max. gross power. 10 HP - 7,5Kw @ 3600 rpm
Electrical start 12 volt

ELECTRIC MOTOR

Standard230V / 50 Hz - 2,2 Kw
Optional110V / 50 Hz - 2,2 Kw

HYDRAULIC PUMPS

Pump diesel engineno. 2 gear pumps
Pump electric motorno. 2 gear pumps

TRACKED UNDERCARRIAGE

Track tensionergrease-filled
Rollers no. per side3 + slide
Widening system.....786 / 1086 mm
Translation speed 1,3 km/h
Translation speed (with optional high speed) 1,7 / 3,3 km/h

WEIGHT MACHINE 2100 kg
MAX UPPER SLANT 15° / 26,8%
MAX WIND SPEED 12,5 m/s



TRACKED AERIAL PLATFORMS

GOLDLIFT 17.80XL **ITS** LITHIUM **ION**

ELECTRIC SYSTEM

Electric system voltage.....	48V-12V
Lithium battery pack.....	4,8 KWh
Autonomy (continuous cycle)*	4-5 h
Onboard battery charger	220V 50Hz
Optional battery charger	110V 50Hz
Recharge time on flat batteries.....	4 h (indicative)
Recharge time to 80% on flat batteries.....	2 h (indicative)

HYDRAULIC PUMPS

Electric motor	no.2 gear pumps
----------------------	-----------------

TRACKED UNDERCARRIAGE

Track tensioner	grease-filled
Rollers no. per side	3 + slide
Widening system	786 - 1086 mm
Translation speed	0,9 km/h
Second translation speed (optional)	1,1 / 2,1 km/h

WEIGHT MACHINE	2190 kg
MAX UPPER SLANT	15° / 26,8%
MAX WIND SPEED	12,5 m/s

CHERRYPICKER·IE



Sales & Service



Bespoke Design



MEWP Training



Handling Solutions

